

D7704

AI Omnidirectional Microphone



Description

The AI omnidirectional microphone is an advanced smart microphone that combines AI algorithms with cutting-edge voice technology. It features innovative AI sound capture, AI noise reduction, AI dereverberation, intelligent echo cancellation, and a 2.1-channel speaker system, all designed for high-fidelity audio.

The device employs advanced beamforming technology and a new patented invention to achieve more precise multi-beam localization of speakers. This technology allows for more accurate capture of direct speech while suppressing multiple reflected sound waves, effectively reducing indoor reverberation in various meeting spaces and conversational environments. It eliminates the spatial and hollow qualities of the speaker's voice, ensuring clear and natural sound that is easy for the recipient to understand. These advanced AI dereverberation effects enable the device to perform exceptionally well in rooms with reflective glass surfaces and in conference environments with heavy reverberation and high, empty spaces, providing clear and pure voice quality without reverberation or muddiness.

The device features an array of 6 high-definition microphones, with an optimal pickup range of up to 6 meters, suitable for conference rooms up to 30 square meters. It supports both Bluetooth and USB communication and can be used with a Bluetooth adapter for wireless calls.

Features

- Advanced AI technology for voice pickup, noise reduction, dereverberation, and echo cancellation.
- The world's first 2.1-channel speaker system equipped with a three-speaker setup, including stereo and subwoofer speakers.
- DSP-calibrated equalizer, delivering high-fidelity audio with adjustable settings for both calls and music.
- 6 built-in high-definition microphones: Equipped with an array of 6 microphones with a pickup range of up to 6 meters.
- Support both Bluetooth and USB communication, facilitating integration with a variety of devices and systems.

Specifications

Model	D7704
USB Communication	Support
Bluetooth Communication	Support
Wireless Communication	Bluetooth Adapter (Optional)
Omnidirectional Pickup	6m
Directional Pickup	90°
Built-in Microphone	6
Built-in Speaker	3
DSP	Support
AI Noise Reduction	Support
AI Dereverberation	Support
AI Auto Gain	Support
Built-in Lithium Battery	5200mAh

Front / Rear Panel

Button Indicator Description

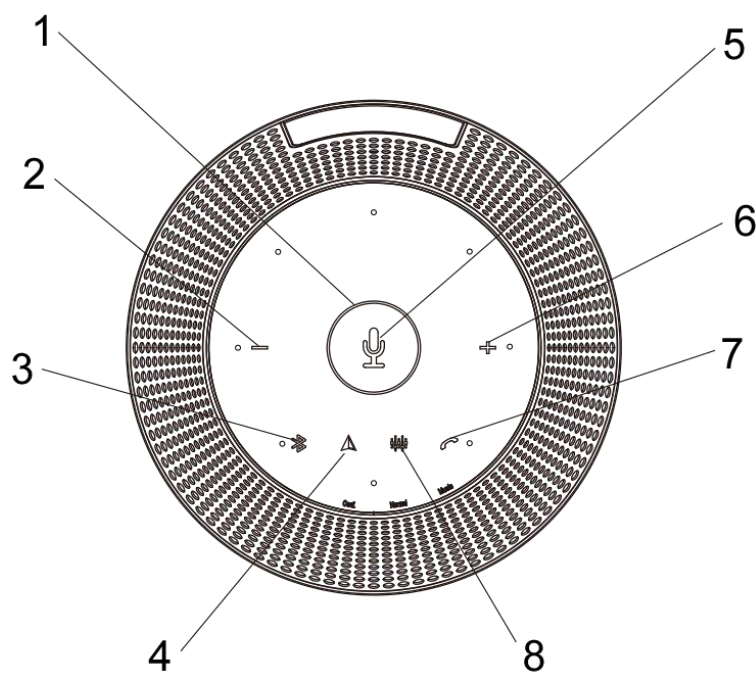

1. Ring Indicator: When the device is powered on, short press the power button, and the ring indicator light will display the battery level.

2. Volume - Button: Press the volume - button to decrease the volume, and the ring indicator light will decrease in white. When the volume is at zero, the ring indicator light will be red and normally on.

3. Bluetooth Button: Short press the Bluetooth button to enter pairing mode, and the blue indicator light will flash during pairing. Once Bluetooth connection is successful, the blue indicator light will be normally on. Short press the button again to turn off Bluetooth, and the white indicator light will be normally on.

4. Directional Button: Short press the directional button to switch modes. The directional indicator light will be normally orange in directional mode and normally white in non-directional mode.

The circular light changes as the volume is increased or decreased. (Note: When switching to directional

mode, the ring indicator light will only show 45% in white. The ring indicator light will change accordingly when increasing/decreasing the volume.)

5. Microphone Mute Button: When the microphone is muted, the microphone indicator light will be normally red; when unmuted, the indicator light will be normally white.

6. Volume + Button: Press the volume + button to increase the volume, and the ring indicator light will increase in white.

7. Off-hook/On-hook Button: The off-hook/on-hook function is available in Bluetooth mode. When receiving a call, the white indicator light will flash. Short press to answer the call, and the white indicator light will be normally on. Short press again to end the call, and the white indicator light will be normally on.

8. EQ Mode Switching Button: Short press the EQ mode button to switch between Conference mode (Conf. white indicator light normally on), Normal mode (Normal white indicator light normally on), and Music mode (Music white indicator light normally on) based on your needs.

Interface Description

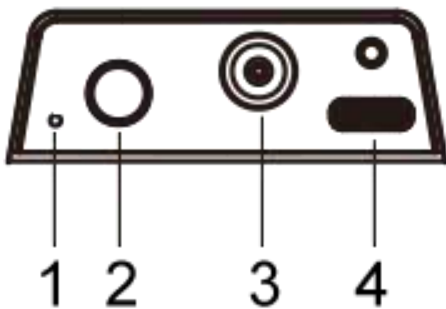

1. Charging Indicator: The green indicator light is normally on while charging, and goes off when fully charged.

2. Power Button

3. Power Port

4. Type-C port

Bluetooth Adapter Description

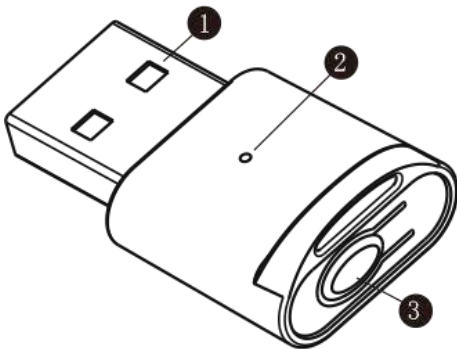

❶ USB Power and Audio Connector

❷ Device LED Indicator

❸ Device Operation Button

● LED Status Description

Device LED Indicator	Fast Flashing (flashing once every 300ms)	Slow Flashing (flashing once every 1s)
	Device search and pairing status	Successfully connected

● Button Description

Device Operation Button	Press and hold for 5 seconds	Clear pairing records
-------------------------	------------------------------	-----------------------

Bluetooth pairing: Insert the adapter into the conference device, which will automatically enter pairing mode with a fast-flashing indicator light. Turn on the omnidirectional microphone's Bluetooth function. Once paired successfully, the indicator light will switch to slow flashing.